

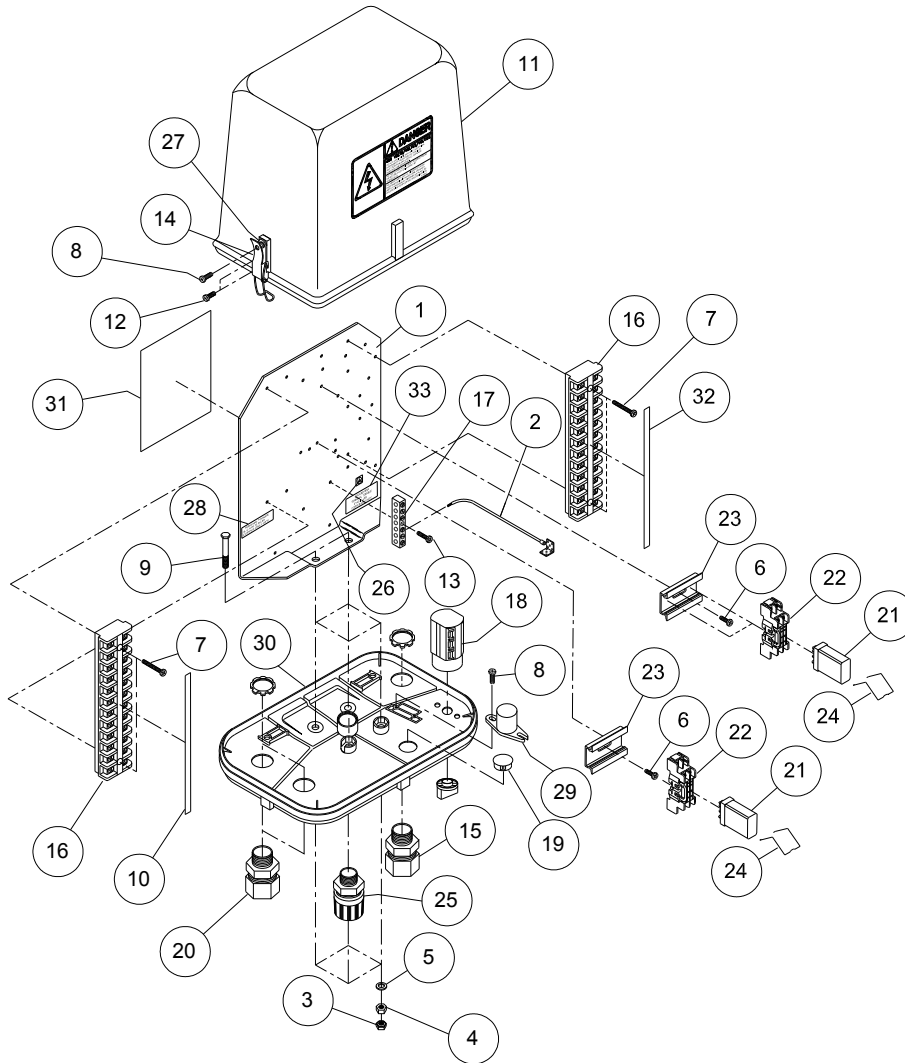

# Tower Panels

## Panel, Junction, FieldPLUS, 11-7931-6



Ref.	Original Part No.	Substitute Part No.	Description
1	03-4017-4		Plate, Starter Mount
2	03-4629-6		Termifoil Assembly
3	06-0262-3		Nut, 5/16-18, Lock, Nylon Insert
4	06-0822-4		Nut, 5/16"-18, Hex
5	06-0842-2		Washer, Flat, 1/4"
6	06-0847-1		Screw, #8-32 x 3/8", Ph Pn Hd, #23
7	06-0850-5		Screw, #8-32 x 1", Ph. Pn. Hd, #23
8	06-0856-2		Screw, #6-20 x 1/2", Ph.Pan Hd, #25
9	06-3146-5		Screw, 5/16-18 x 1-1/2", Hex, Gr. 5
10	06-4071-4		Decal, Terminal Marker, N-L, 10W
11	06-4208-2		Shield, Tower Box, Gray, 480 Decal
12	06-4234-8		Screw, #6-20 x 3/8", Ph.Pn.Hd., #25
13	06-4553-1		Screw, #8-32 x 3/4", Ph.Pn.Hd., #23
14	06-4822-0		Latch, Pull Down, 3 Hole
15	09-0838-4		Connector, 3/4" w/Nut, .7-.8" Dia.
16	09-7602-7		Block, Term, 12 Pt., #CR151B26AF
17	09-7631-6		Bar, Ground Terminal, 6-#14, 6-#8

Ref.	Original Part No.	Substitute Part No.	Description
18	09-8866-7		Switch, Rotary Pwr, 6 PST, 10 AMP
19	09-8986-3		Plug, Hole, Nylon, 7/8"
20	09-9183-6		Connector, 3/4" w/Nut, .6-.7" Dia.
21	11-0015-5		Relay, Plug-In
22	11-0016-3		Socket, Relay, DPDT, 7 Amp, 300V
23	11-1788-6		Rail, Din, 2"
24	11-1797-7		Spring, Relay Retainer, SPDT
25	11-2835-4		Connector, 1/2", w/o Nut, .37-.5 Dia.
26	11-7357-4		Decal, Protective Earth (GRD)
27	11-7429-1		Sleeve, Captive, Tower Box
28	11-9047-0		Decal Terminal Torque, GE
29	12-2401-0		Switch, Tilt
30	12-2407-0		Base, J-Panel
31	12-2408-0		Decal, Wiring Diagram, J-Panel
32	12-2409-0		Decal, Terminal Marker
33	13-7555-0		Decal, Terminal Torque, Groundbar