

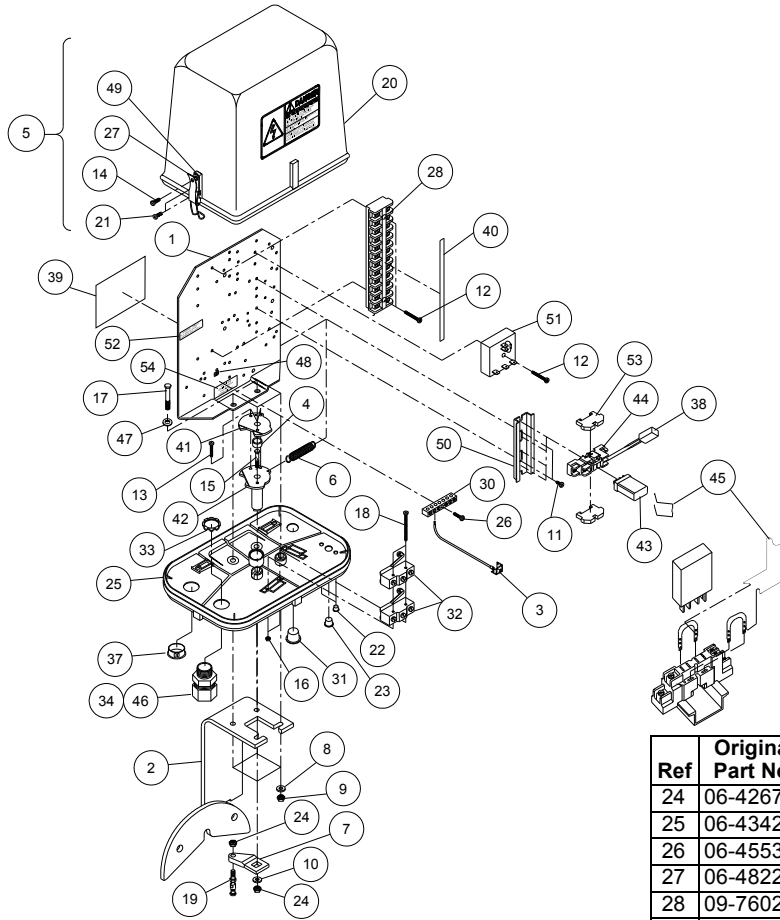

Tower Panels

Auto Rev/Stop Control Panel, Any Tower, 10-0052-0



Ref.	Original Part No.	Substitute Part No.	Description
1	03-4017-4		Plate, Starter Mount, Model 2
2	03-2822-9		Mount Weld., Twr. Box, Sq. Mount
3	03-4629-6		Termifoil Assembly
4	03-5954-7		Spacer, Cam
5	03-7641-8		Shield Assy, Tower Ctrl. Box, Gray
6	06-0212-8		Spring, Special, Plated, #E-41-C
7	06-0460-3		Arm, Cam, Tower Control Box
8	06-0812-5		Washer, Lock, 5/16"
9	06-0822-4		Nut, 5/16"-18, Hex
10	06-0842-2		Washer, Flat, 1/4"
11	06-0847-1		Screw,#8-32 x 3/8",Ph Pn Hd,#23
12	06-0850-5		Screw, #8-32 x 1", Ph. Pn. Hd, #23
13	1600827		Screw, #6-20x7/8",Ph. Pan Hd.,#25
14	06-0856-2		Screw, #6-20 x 1/2",Ph.Pan Hd,#25
15	06-1580-7	11-8405-0	Screw, 1/4-20 x 1", Hex, Stainless
16	06-2200-1		Nut, 6-32, Hex
17	06-3146-5		Screw, 5/16-18 x 1-1/2", Hex, Gr. 5
18	06-3758-7		Screw, #6-32 x 2", Sl. Pn. Hd.
19	06-3910-4		Swivel, Set Screw, 1/4", 5/16" Rod
20	06-4208-2		Shield, Tower Box, Gray,480 Decal
21	06-4234-8		Screw, #6-20 x 3/8", Ph.Pn.Hd.,#25
22	06-4235-5		Plug, Hole, Nylon, 1/4 x.062" Thick
23	06-4264-5		Plug, Hole, Nylon, 1/2"

Ref	Original Part No.	Substitute Part No.	Description
24	06-4267-8		Nut, 1/4-20, Lock, Nylon Insert
25	06-4342-9		Base, Tower Control Box, Gray
26	06-4553-1		Screw, #8-32 x 3/4",Ph.Pn.Hd.,#23
27	06-4822-0		Latch, Pull-Down, 3 Hole
28	09-7602-7		Block,Term.,12 Pt.,#CR151B26AF
29	09-7608-4		Term., Wire, B, #16-14, Spade 8,Ins
30	09-7631-6		Bar, Ground Terminal, 6-#14, 6-#8
31	09-8986-3		Plug, Hole,Nyl.,7/8,Heyco,#DP-875
32	16-0083-6		Switch, Micro,SPDT,15A,120V,w/R
33	09-9161-2		Nut, Conduit, 3/4", Lock
34	09-9183-6		Connector, 3/4" w/Nut, .6-.7 Dia.
35	09-9211-5		Terminal, Slip-On, 16-14-1/4"
36	09-9226-3		Terminal, 1/4", Slip-On, Piggyback
37	09-9297-4		Plug, Hole, 1-1/8" Nylon
38	09-9341-0		Suppressor, RC, 200 VDC, Mod. 2
39	10-0054-6		Decal, Nameplate, Auto Rev/Stop
40	10-0055-3		Decal, Term. Marker, Auto Rev/Stop
41	10-0056-1		Cam, Short, Auto Rev/Stop
42	10-0057-9		Cam, Long, Auto Rev/Stop
43	10-0060-3		Relay, Plug-In, SPDT
44	10-0061-1		Socket, Relay, Plug-In, 5 Bl., 300V
45	11-1797-7		Spring, Relay Retainer, SPDT
46	11-2836-2		Connector, 3/4" w/o Nut, .6-.7" Dia.
47	11-3530-0		Washer, Lock, 5/16", Internal Tooth
48	11-7357-4		Decal, P.E., Ground Symbol
49	11-7429-1		Sleeve, Captive, Tower Box
50	11-7787-2		Rail, Din, 4"
51	11-7940-7		Timer Assembly, 3.3 Second, N.C.
52	11-9047-0		Decal, Terminal Torque, GE
53	12-4620-0		Block, Terminal,Endstop, Screwless
54	13-7555-0		Decal, Terminal Torque, Groundbar