

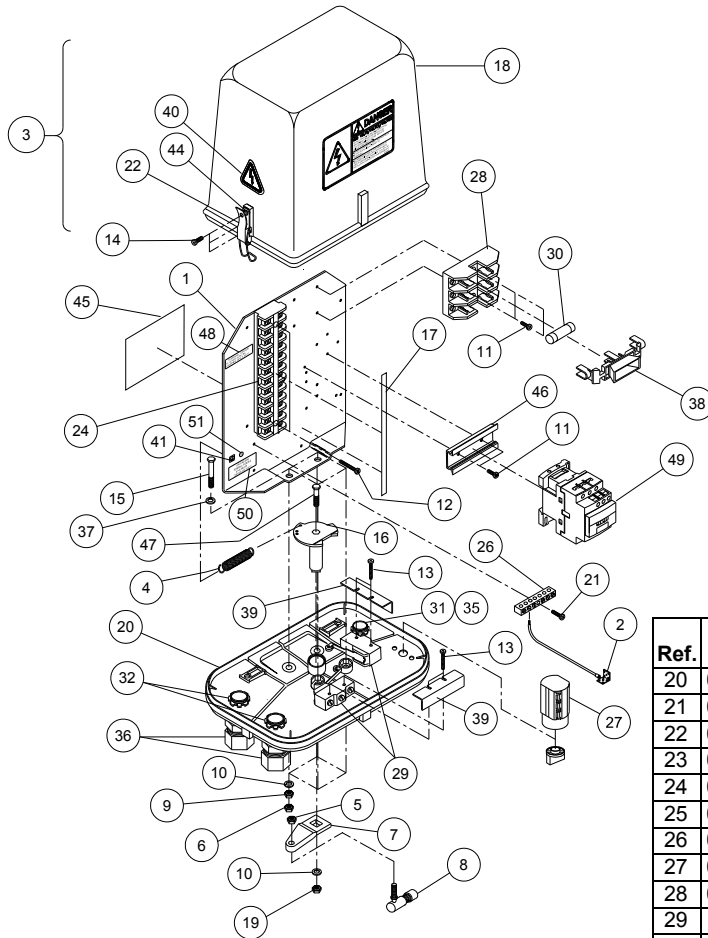

Tower Panels

CE Tower Panels (International Panels)

Tower Control Panel, Std. 10 Wire, CE, 11-7326-9



Ref.	Original Part No.	Substitute Part No.	Description
1	03-4017-4		Plate, Starter Mount
2	03-4629-6		Termifoil Assembly
3	03-7641-8		Shield Assy, Tower Panel, Gray
4	06-0212-8		Spring, Special, Plated, #E-41-C
5	06-0240-9		Nut, 5/16-24, Hex
6	06-0262-3		Nut, 5/16-18, Lock, Nylon Insert
7	06-0460-3		Arm, Cam, Tower Control Panel
8	06-0470-2		Joint, Ball, Quick Disconnect
9	06-0822-4		Nut, 5/16-18, Hex
10	06-0842-2		Washer, Flat, 1/4"
11	06-0847-1		Screw, #8-32 x 3/8", Ph. Pn. Hd., #23
12	06-0850-5		Screw, #8-32 x 1", Ph. Pn. Hd., #23
13	11-5243-8		Scrw, #6-20x1-1/4", Ph. Pn Hd., #25
14	06-0856-2		Screw, #6-20 x 1/2", Ph. Pn Hd., #25
15	06-3146-5		Screw, 5/16-18 x 1-1/2", Hex, Gr. 5
16	06-3751-2		Cam, Tower Panel, Plastic
17	06-4071-4		Decal, Term. Marker, Std., N-L, 10W
18	06-4208-2		Shield, Tower Box, Gray, 480 Decal
19	06-4267-8		Nut, 1/4-20, Lock, Nylon Insert

Ref.	Original Part No.	Substitute Part No.	Description
20	06-4342-9		Base, Tower Control Panel, Gray
21	06-4553-1		Screw, #8-32 x 3/4", Ph. Pn. Hd., #23
22	06-4822-0		Latch, Pull-Down, 3 Hole
23	09-0816-0		Tie, Cable, Plastic, 5-1/2" Long
24	09-7602-7		Block, Term, 12Pt, #CR151B26AF
25	09-7608-4		Term., Wire, B, #16-14, Spade 8, Ins
26	09-7631-6		Bar, Ground Terminal, #6-#14, 6-#8
27	09-8866-7		Switch, Rotary Pwr, 6 PST, 10 AMP
28	09-8923-6		Fuseholder, 600V, 30 AMP, 3 Pole
29	16-0083-6		Switch, Micro, SPDT, 15A, 120 Volt
30	09-9064-8		Fuse, 5 AMP, 500 Volt, D.E.T.D.
31	09-9156-2		Nut, Conduit, 1/2"
32	09-9161-2		Nut, Conduit, 3/4"
33	09-9341-0		Suppressor, ARC, 200 VDC, Model 2
34	10-1726-8		Kit, Control Rod
35	11-2835-4		Connector, 1/2" w/o Nut, .37-.5" Dia.
36	11-2836-2		Connector, 3/4" w/o Nut, .6-.7" Dia.
37	11-3530-0		Washer, Lock, 15/16", Int. Tooth
38	11-7352-5		Cover, Fuseholder, CE
39	11-7353-3		Shield, Micro-Switch, CE
40	11-7354-1		Decal, Electric Shock, ISO/CE
41	11-7357-4		Decal, Protective Earth (GRD)
42	11-7397-0		Terminal, Tubular, 14 AWG
43	11-7398-8		Terminal, Tubular, 16 AWG
44	11-7429-1		Sleeve, Captive, Tower Box
45	11-7433-3		Decal, Schem, Std. Tower Panel, CE
46	11-7444-0		Rail, Din, 3"
47	11-8405-0		Screw, 1/4-20 x 1", Hex
48	11-9047-0		Decal, Terminal Torque, GE
49	12-0743-0		Contact, Tower, 18 A, NC, NO, CE
50	13-7555-0		Decal, Terminal Torque, Groundbar
51	14-8366-0		Decal, Green/Yellow, "PE"