

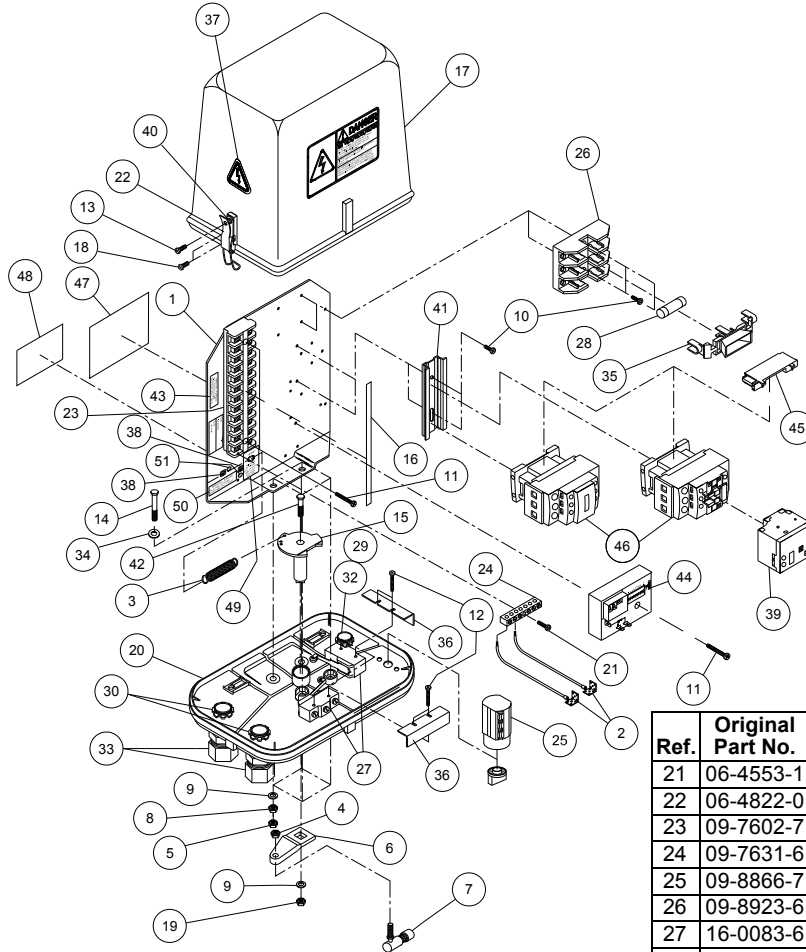

Tower Panels

Tower Control Panel, Next-Last, 10 Wire, CE, 12-0752-0



Ref.	Original Part No.	Substitute Part No.	Description
1	03-4017-4		Plate, Starter Mount
2	03-4629-6		Termifoil Assembly, CE
3	06-0212-8		Spring, Special, Plated
4	06-0240-9		Nut, 5/16-24, Hex
5	06-0262-3		Nut, 5/16, Lock Nut, Nylon Insert
6	06-0460-3		Arm, Cam, Tower Control Panel
7	06-0470-2		Joint, Ball, Quick Disconnect
8	06-0822-4		Nut, 5/16-18, Hex
9	06-0842-2		Washer, Flat, 1/4"
10	06-0847-1		Screw, #8-32 x 3/8", Ph Pn Hd, #23
11	06-3909-6		Screw, #8-32x1-1/4, Ph.Pn.Hd, #23
12	11-5243-8		Scrw, #6-20 x 1-1/4, Ph. Pn Hd., #25
13	06-0856-2		Screw, #6-20 x 1/2", Ph.Pan Hd, #25
14	06-3146-5		Screw, 5/16-18 x 1-1/2", Hex, Gr. 5
15	06-3751-2		Cam, Tower Panel, Plastic
16	06-4071-4		Decal, Term. Marker, Std, N.L., 10W
17	06-4208-2		Shield, Tower Box, Gray, 480 Decal
18	06-4234-8		Screw, #6-20 x 3/8", Ph. Pan Head
19	06-4267-8		Nut, 1/4-20, Lock, Nylon Insert
20	06-4342-9		Base, Tower Control Panel, Gray

Ref.	Original Part No.	Substitute Part No.	Description
21	06-4553-1		Screw, #8-32 x 3/4", Ph. Pn. Hd.
22	06-4822-0		Latch, Pull Down, 3 Hole
23	09-7602-7		Block, Term, 12Pt, #CR151B26AF
24	09-7631-6		Bar, Ground Terminal, 6-#14, 6-#8
25	09-8866-7		Switch, Rotary Pwr, 6 PST, 10 AMP
26	09-8923-6		Fuseholder, 600V, 30 AMP, 3 Pole
27	16-0083-6		Switch, Micro, SPDT, 15A, 120 Volt
28	09-9064-8		Fuse, 5 AMP, 500 Volt, D.E.T.D.
29	09-9156-2		Nut, Conduit, 1/2"
30	09-9161-2		Nut, Conduit, 3/4"
31	10-1726-8		Kit, Control Rod
32	11-2835-4		Connector, 1/2" w/o Nut, .37-.5" Dia
33	11-2836-2		Connector, 3/4" w/o Nut, .6-.7" Dia.
34	11-3530-0		Washer, Lock, 5/16", Internal Tooth
35	11-7352-5		Cover, Fuseholder, CE
36	11-7353-3		Shield, Micro-Switch, CE
37	11-7354-1		Decal, Electric Shock, ISO/CE
38	11-7357-4		Decal, Protective Earth (GRD)
39	11-7392-1		Latch, Relay, 120V
40	11-7429-1		Sleeve, Captive, Tower Box
41	11-7787-2		Rail, Din, 4"
42	11-8405-0		Screw, 1/4-20 x 1", Hex
43	11-9047-0		Decal, Terminal Torque, GE
44	13-3567-0		Timer, Relay, 1-127M, Stall
45	12-0739-0		Snubber, RC, 110-250V, Snapin
46	12-0743-0		Contactor, Twr, 18A, NC, NO, CE
47	12-0786-0		Decal, Nameplate, N-L Twr Pnl, CE
48	12-0787-0		Decal, Comp.ID, NTL, Twr Pnl, CE
49	12-0788-0		Decal, Timer, Tower Panel, CE
50	13-7555-0		Decal, Terminal Torque, Groundbar
51	14-8366-0		Decal, Green/Yellow, "PE"
52	14-8388-0		Terminal, 1/4 Slip-on, Pgy-Bk