

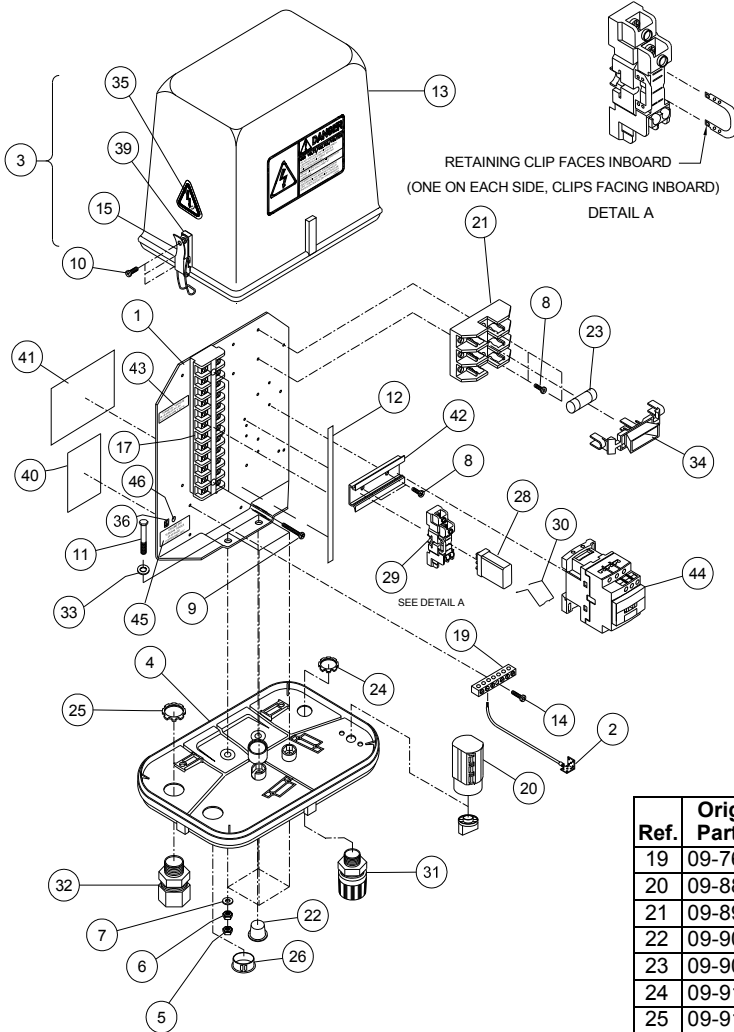

# Tower Panels

## Tower Control Panel, Last, 10 Wire, CE, 11-7328-5



Ref.	Original Part No.	Substitute Part No.	Description
1	03-4017-4		Plate, Starter Mount
2	03-4629-6		Termifoil Assembly
3	03-7641-8		Shield Assy, Tower Panel, Gray
4	03-7763-0		Base, Tower Box, Threaded
5	06-0262-3		Nut, 5/16-18, Lock, Nylon Insert
6	06-0822-4		Nut, 5/16-18, Hex
7	06-0842-2		Washer, Flat, 1/4"
8	06-0847-1		Screw, #8-32 x 3/8", Ph. Pn. Hd #23
9	06-0850-5		Screw, #8-32 x 1", Ph. Pn. Hd., #23
10	06-0856-2		Screw, #6-20 x 1/2", Ph. Pn. Hd #25
11	06-3146-5		Screw, #5/16-18 x 1-1/2", Hex, Gr. 5
12	06-4074-8		Decal, Term. Marker, Last, 10W
13	06-4208-2		Shield, Tower Box, Gray, 480 Decal
14	06-4553-1		Screw, #8-32 x 3/4", Ph. Pn. Hd #23
15	06-4822-0		Latch, Pull Down, 3 Hole
16	09-0816-0		Tie, Cable, Plastic, 5-1/2" Long
17	09-7602-7		Block, Term, 12Pt, #CR151B26AF
18	09-7608-4		Term., Wire, B, #16-14, Spade 6, Ins

Ref.	Original Part No.	Substitute Part No.	Description
19	09-7631-6		Bar, Ground Terminal, 6-#14, 6-#8
20	09-8866-7		Switch, Rotary Pwr, 6 PST, 10 AMP
21	09-8923-6		Fuseholder, 600V, 30 AMP, 3 Pole
22	09-9020-0		Plug, Caplug #9X
23	09-9064-8		Fuse, 5 AMP, 500 Volt, D.E.T.D.
24	09-9156-2		Nut, Conduit, 1/2"
25	09-9161-2		Nut, Conduit, 3/4"
26	09-9297-4		Plug, Hole, 1-1/8", Nylon
27	09-9341-0		Suppressor, ARC, 200 VDC, Mod. 2
28	10-0060-3		Relay, Plug-In, SPDT
29	10-0061-1		Socket, Relay, Plug-In, 300V
30	11-1797-7		Spring, Relay Retainer, SPDT
31	11-2835-4		Connector, 1/2" w/o Nut, .37-.5" Dia.
32	11-2836-2		Connector, 3/4" w/o Nut, .6-.7" Dia.
33	11-3530-0		Washer, Lock, 5/16", Int. Tooth
34	11-7352-5		Cover, Fuseholder, CE
35	11-7354-1		Decal, Electric Shock, ISO/CE
36	11-7357-4		Decal, Protective Earth (GRD)
37	11-7397-0		Terminal, Tubular, 14 AWG
38	11-7398-8		Terminal, Tubular, 16 AWG
39	11-7429-1		Sleeve, Captive, Tower Box
40	11-7432-5		Decal, Comp, I.D., Last Twr Pnl, CE
41	11-7435-8		Decal, Schem, Last Tower Panel, CE
42	11-7444-0		Rail, Din, 3"
43	11-9047-0		Decal, Terminal Torque, GE
44	12-0743-0		Contact, Tower, 18A, NC, NO, CE
45	13-7555-0		Decal, Terminal Torque, Groundbar
46	14-8366-0		Decal, Green/Yellow, "PE"